

# CONTROL DRAWING

21\_PSM-50-4-1

D

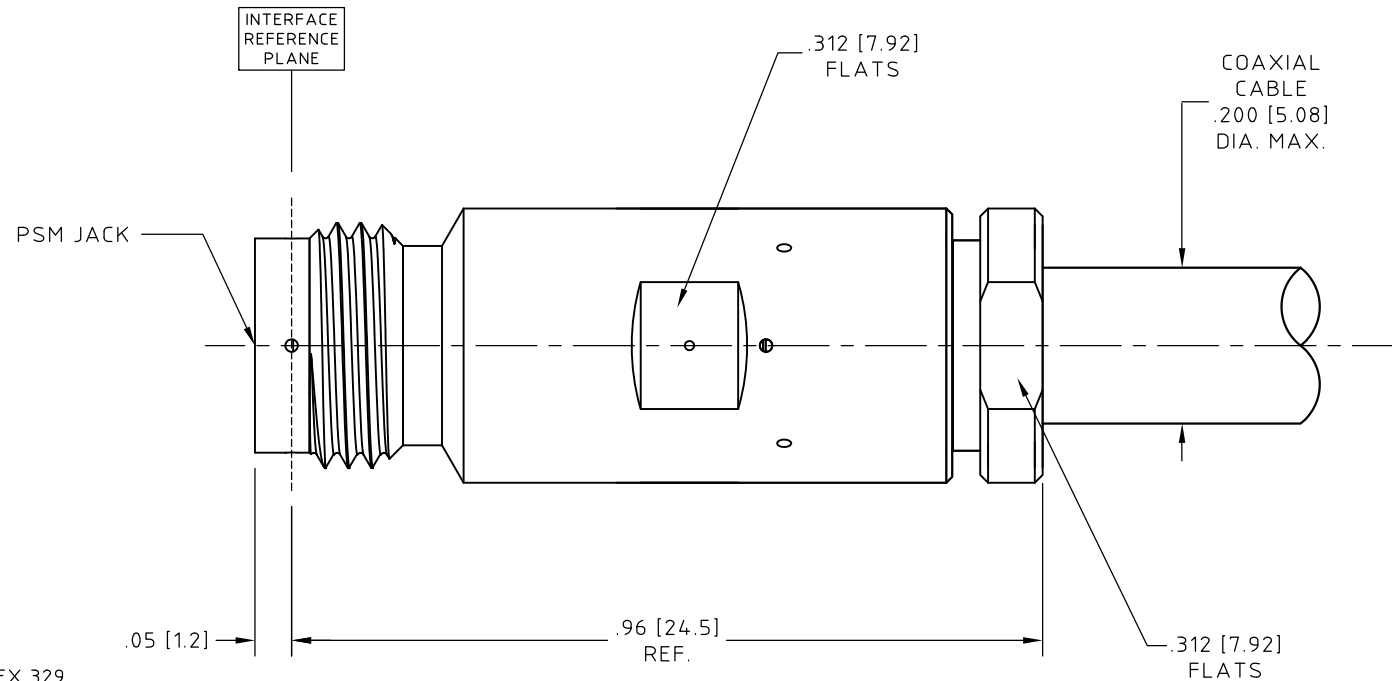

**NOTES:**

1. DESCRIPTION,  
CONNECTOR, PRECISION PSM JACK,  
FOR HUBER+SUHNER ASTROLAB SUCOFLEX 329.  
CONNECTOR IS LOW OUTGASSING AND MEETS  
NASA REQUIREMENTS FOR SPACE APPLICATIONS.
2. MATERIALS AND FINISHES,  
BODY, RETAINING NUT, SOLDER BUSHING AND CONTACT,  
BERYLLIUM COPPER ALLOY PER ASTM B-196,  
UNS No. C17300, TEMPER TD04(H).  
GOLD PLATED 100 μIN (2.54 μM) MIN. THK.  
PER ASTM B-488, CODE C, TYPE II,  
OVER  
30 μIN (0.76 μM) MIN. COPPER FLASH.  
DIELECTRIC,  
POLYTETRAFLUOROETHYLENE (PTFE) PER ASTM D-1710,  
OR ASTM D-4894, TYPE I, GRADE 1.
3. ELECTRICAL CHARACTERISTICS:  
IMPEDANCE  
50.0 Ohms NOMINAL.
4. PSM JACK INTERFACE IAW HUBER+SUHNER A.G.  
PUBLISHED INFORMATION.
5. OPERATING TEMPERATURE RANGE  
-55° C TO +125° C

NAME	DATE	<p style="font-size: small;">THIS DRAWING CONTAINS PATENTABLE AND PROPRIETARY INFORMATION. THE DESIGN CANNOT BE USED WITHOUT WRITTEN PERMISSION OF HUBER + SUHNER ASTROLAB.</p>
PREP. LEF	11/03/16	
ELEC.		
MECH. GSG	11/22/16	
Q.C.		
TITLE		

UNLESS OTHERWISE SPECIFIED  
CONCENTRICITY .004 T.I.R.  
CORNERS AND FILLETS .005  
MAX. RADIUS OR CHAMFER.  
SURFACE FINISH 63 RMS  
MICROINCHES OR BETTER.

FRACTIONS	± 1/16
X	± .030
XX	± .015
XXX	± .005
ANGLES	± 1°
DO NOT SCALE DRAWING	

CONNECTOR, SPACE, PSM JACK, SUCOFLEX 329				
THDS. TO BE IN ACCORD WITH U.S. DEPT. OF COMM. SCREW THD. STDS. FOR FEDERAL SERVICES 1950 SUPL. TO HANDBOOK H 28.	SCALE 4:1	CODE IDENT. 16301	DWG NO. 21_PSM-50-4-1	REV D

D	ECN No. 20324	06/19/18	KF	
REV.	DESCRIPTION	DATE	BY	APPROVED