

CONTROL DRAWING

29981-DCM4

B

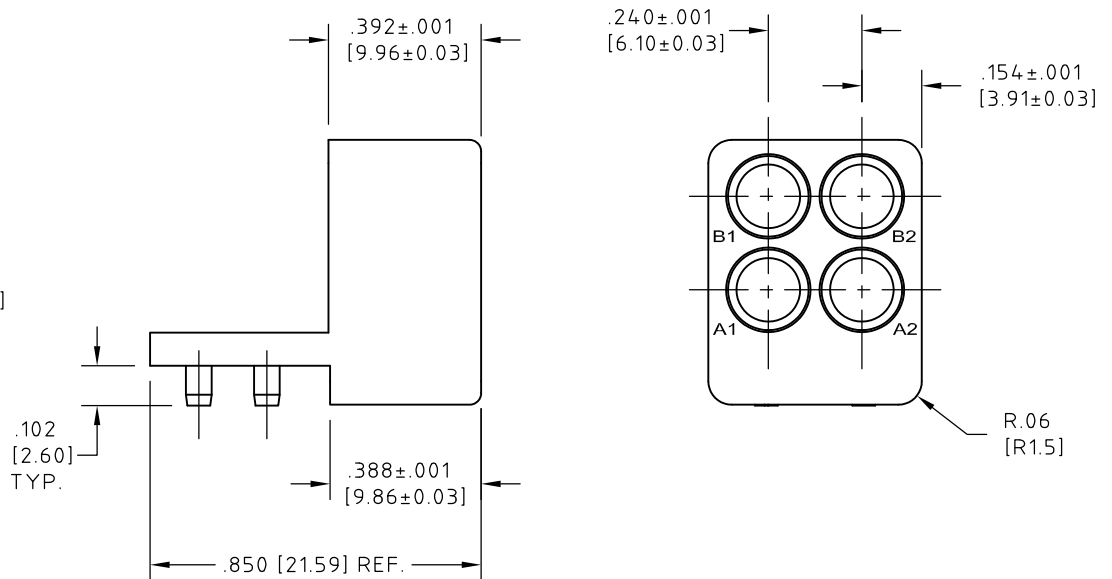
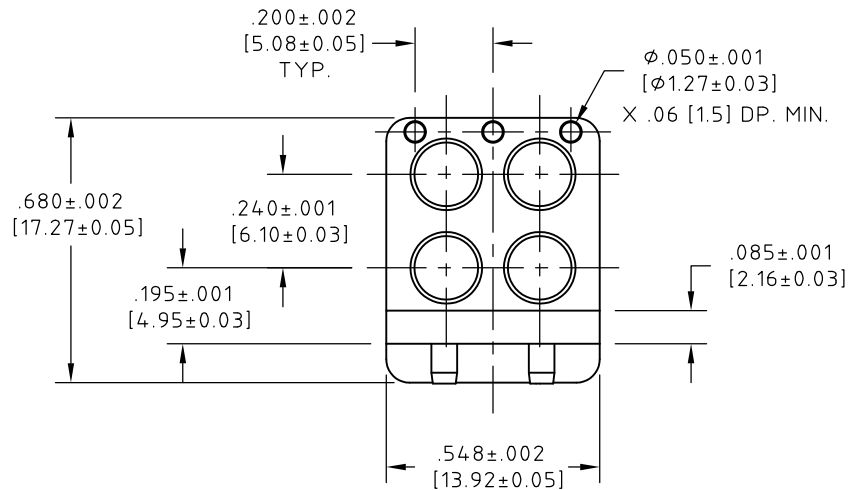
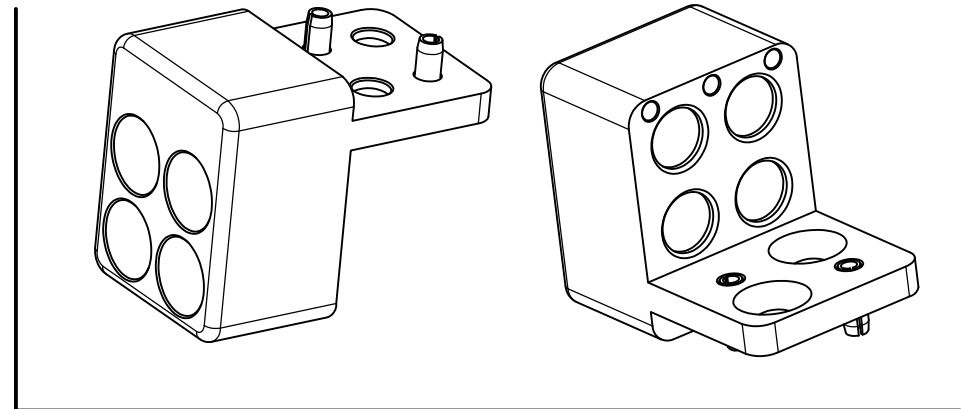
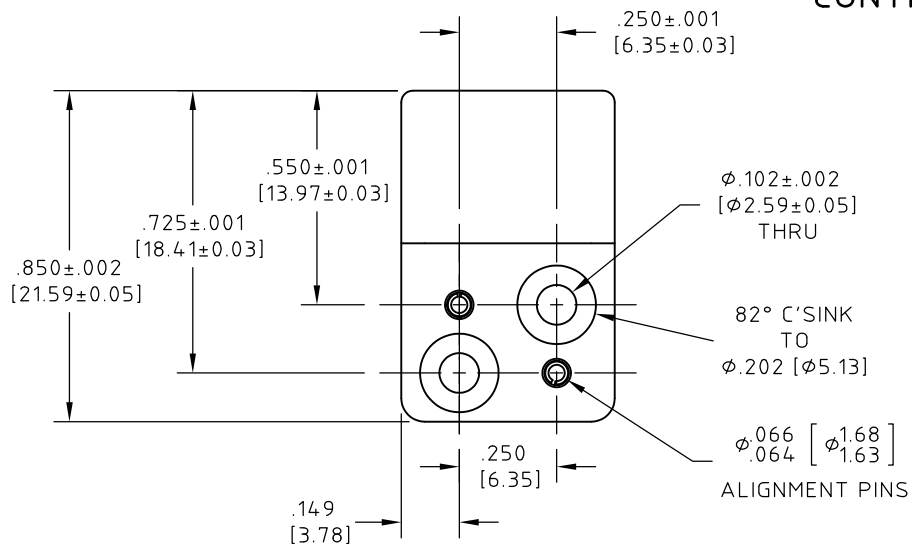

NOTES:

1. DESCRIPTION:
PLUG-IN MODULE, FOR (4) SMPM CONNECTORS IAW VITA 67.1

2. MATERIALS AND FINISHES:
MODULE
STEEL, CORROSION RESISTANT PER ASTM A-582,
UNS No. S30300, COND. A, NON MAGNETIC,
PASSIVATED PER SAE-AMS-2700.
NO DICHROMATE SOLUTIONS USED.
ALIGNMENT PINS
STEEL, CORROSION RESISTANT PER
ASTM A-313, UNS No. S30200.
PASSIVATED PER SAE-AMS-2700.

UNLESS OTHERWISE SPECIFIED
CONCENTRICITY .004 T.I.R.
CORNERS AND FILLETS .005
MAX. RADIUS OR CHAMFER.
SURFACE FINISH 63 RMS
MICROINCHES OR BETTER.

FRACTIONS	± 1/16
X	± .030
XX	± .015
XXX	± .005
ANGLES	± 1°
DO NOT SCALE DRAWING	

NAME	DATE
PREP. GSG	03/16/15
ELEC.	
MECH. M.G.	03/27/15
Q.C.	

THIS DRAWING CONTAINS PATENTABLE AND PROPRIETARY INFORMATION. THE DESIGN CANNOT BE USED WITHOUT WRITTEN PERMISSION OF HUBER + SUHRNER ASTROLAB.

TITLE	MODULE, VITA 67.1, (4) CONNECTOR CAVITY		
THDS. TO BE IN ACCORD WITH U.S. DEPT. OF COMM. SCREW THD. STDS. FOR FEDERAL SERVICES 1950 SUPL. TO HANDBOOK H 28.	SCALE	CODE IDENT.	DWG NO.
	2:1	16301	29981-DCM4
REV.			B

B	ECN No. 16998	03/31/15	EB	
REV.	DESCRIPTION	DATE	BY	APPROVED