

INSTALLATION MANUAL

HUBER+SUHNER AG
Fiber Optics
Fiber Management Systems
DOC-0000424718 Rev C
Date: 19/08/2016

Page 1 of 6

Optibox 6

Table of contents

- ASSEMBLY INSTRUCTION . ERROR! BOOKMARK NOT DEFINED.



ASSEMBLY INSTRUCTION

Scope of delivery:

- OTB6 cover
- OTB6 base with snapped-in inlay
- 3 x U-Shape grommets for cable diameter 3-5mm
- 3 x U-Shape grommets for cable diameter 6-8mm
- 3 x U-Shape grommets or cable diameter 9-12mm
- 3 x U-Shape grommets closed
- 4 x cable tie large 3.5 x 100mm
- 6 x cable tie small 2.5 x 87mm
- 4 x PT screw KA 40 x 16mm raised head
- 1 x PT screw KA 40 x 12mm flat head

Required tools:

- Screw driver cross recess
- Drill
- Knife
- Wire cutting pliers
- Cable stripper
- Screws and anchor bolt for wall mounting



Installation

red: Cable entry, cable fixing and U-Shapes cable sealing (grommets)

orange: Cable exit, cable fixing and cable sealing

green: Cable guiding, splice area and position for second cassette

blue: Cable guiding and patching area, U-Shapes

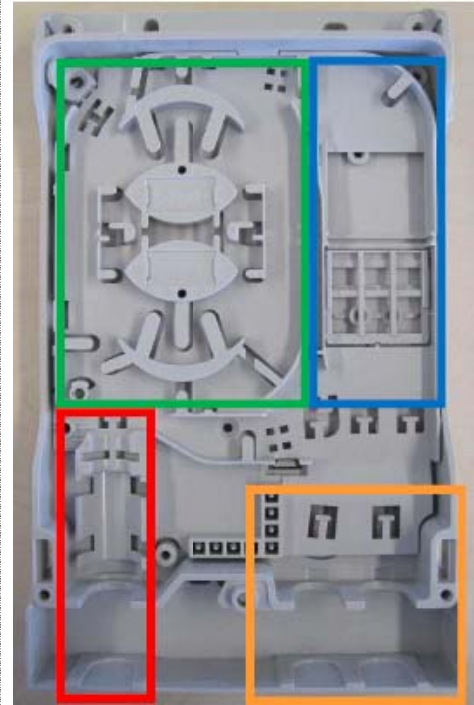
**Step 1****Preparing cable entry**

The OTB6 has many different cable entries and exits. These can be opened depending on the type of installation required. The necessary openings can be opened using pliers. After which, the cables can be inserted using the right sized U-shape grommets. To close the existing openings, closed U-shapes can be used.

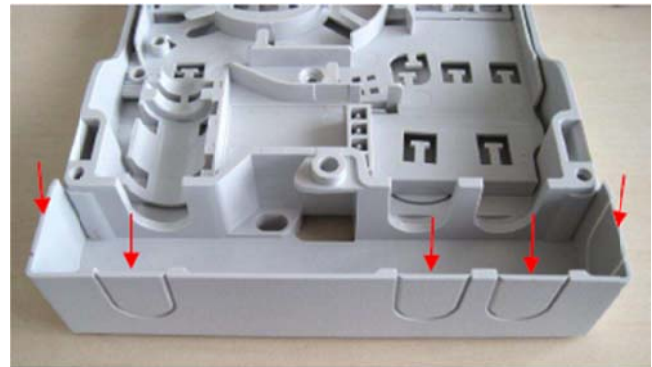

Step 2

Mounting entering cable

The U-Shape grommets must be fixed in the right way using the right sized grommet (the ▲ marking remains out of the box).

Microtube with gas stopper

First, strip microcable over a length of 1500mm. Then, fix the gas stopper with cable ties.

The gas stopper must be positioned with the ▼ marking facing upwards. The aramid thread can be fixed with the strain relief clamp (1). The clamp can be found at the top left part of the inlay and can be snapped off.

Loose tube

The loose tube can be stripped over a length of 1515mm. After that, fix the cable with cable ties.

The aramide thread can fixed using the strain relief clamp (1). The clamp can be found at the top left part of the inlay and can be snapped off.

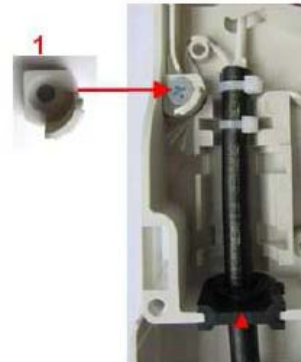

Step 3**Storage of entering fibers:**

The fiber overlength must be coiled clockwise in the interior channel of the fiber management cassette (red ellipse)

For a length of 1500mm, up to 5 coils can be stored in the cassette

Unused fibers can be stored in the storage space (A)

For the last quarter loop, fibers can be routed in the exterior channel and lead onto the splice holder.

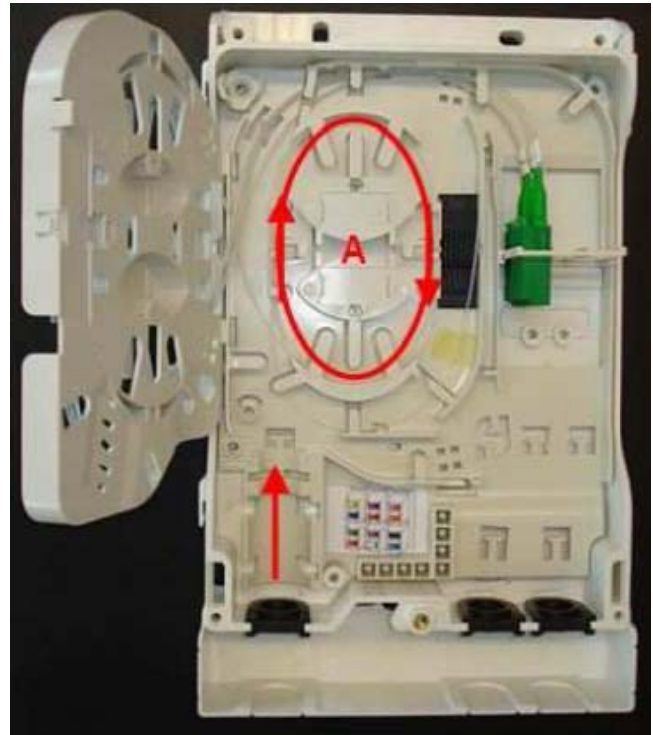
**Step 4****Installing adaptor field**

The adaptor field can be snapped out of the inlay (as shown in the photo) and then be snapped back in again. The numbers in the adaptor field are used to identify the individual positions.

The second photo shows the adaptor positions when using duplex adaptors.





Step 5**Adding additional cassettes**

The OptiBox6 can be populated with 2 additional cassettes. Both can be snapped-in the same way.

Firstly, the additional cassette as shown in the photo on the right, must be positioned on the inlay. The cassette can then be snapped in to the inlay when applying some pressure.

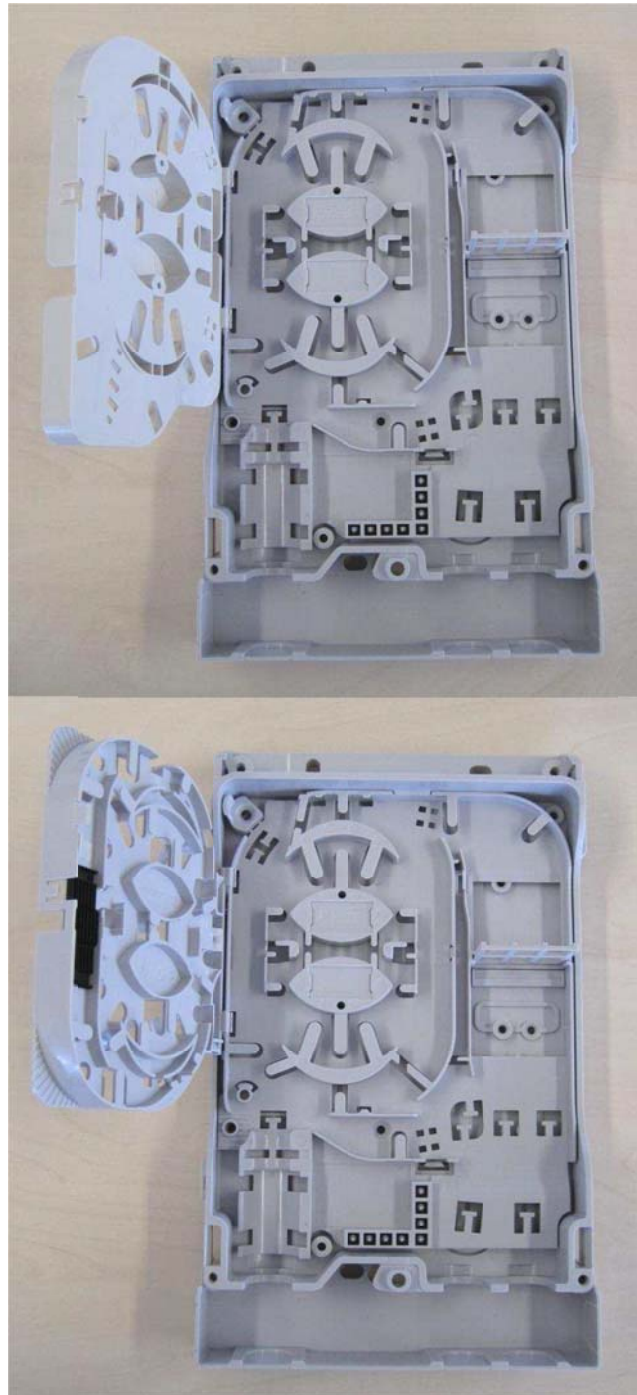
In order to have a better reach of the main inlay, the additional cassettes can be opened and removed from the top of the inlay.



<p>Step 6</p>	<p>Preparing exiting patch cable</p> <p>Route patch cable into the OTB6 and attach with cable ties. Be careful when tightening (lateral pressure)!</p> <p>U-Shape grommets must be positioned correctly (make sure that the ▲ marking faces the outside of the box (both half-shells will thus be held together on the right side)).</p> <p>Move the U-Shape grommets fitted to the cable in the U-shaped cut.</p>	
<p>Step 7</p>	<p>Mounting cover and lock</p> <p>As shown on the drawing, the cover needs to first be placed on the inlay (1). The bottom part can then be fixed to the inlay (2). The 4 KA40 x 16mm screws (3) must then be gently tightened in order to fix the the cover to the base.</p>	